

PUBLIC PATH DIVERSION ORDER UNDER THE HIGHWAYS ACT 1980

POWYS COUNTY COUNCIL

**THE POWYS COUNTY COUNCIL (DIVERSION OF PART OF PUBLIC BRIDLEWAYS GD1457 & GD1461 IN THE COMMUNITY OF GLADESTRY)
PUBLIC PATH DIVERSION ORDER 2017**

This Order is made by Powys County Council ("the Authority") under Section 119 of the Highways Act 1980 ("the 1980 Act") because it appears to the Authority that in the interests of the public it is expedient that the lines of the paths should be diverted.

Powys County Council has agreed to defray any compensation which becomes payable in consequence of the coming into force of this Order and any expenses which are incurred in bringing the new site of the pathways into a fit condition for use by the public.

Gladestry Community Council have been consulted as required by section 120(2) of the 1980 Act.

BY THIS ORDER:

1. The public rights of way over the land situated at Mill Cottage and Llan-y-felin, Gladestry and shown by bold continuous black lines on the plan attached to this Order and described in Part 1 of the Schedule to this Order shall be stopped up after 28 days from the date on which Powys County Council certifies that the works have been completed to bring the highway into a fit condition for use by the public.
2. Notwithstanding this Order any statutory undertaker having apparatus affected by this Order shall have the following rights over the land referred to in paragraph 1 namely access at all reasonable times to maintain or repair statutory apparatus.
3. There shall be after the 28 days referred to in paragraph 1 be public bridleways over the land situated at Mill Cottage and Llan-y-felin described in Part 2 of the Schedule and shown by bold broken black lines on the plan contained in this Order.
4. The rights conferred on the public under this Order shall be subject to the limitations and conditions set out in Part 3 of the Schedule.

THE COMMON SEAL of)
POWYS COUNTY COUNCIL)
was hereunto affixed this 26th day)
of October 2017)
in the presence of:-)



Solicitor to the Council

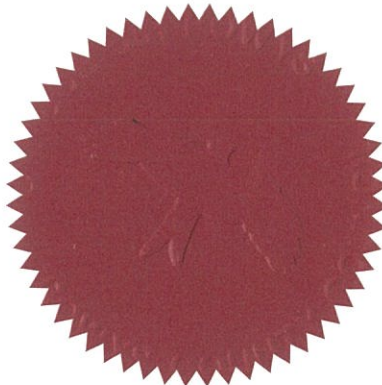

SCHEDULE

PART 1

Description of site of existing path or way

<u>Section of highway as indicated on plan</u>	<u>Position</u>	<u>Width</u>
Bridleway GD1457 Points A-B-C	<p>The section of public bridleway GD1457 to be diverted shown by a bold continuous black line on the attached plan commences at OS Grid Reference SO 2394, 5459 (point A). It follows in a generally north-north-westerly direction for approximately 265 metres through the field boundaries descending the steep wooded slope and through Gladestry Brook before ascending the bank towards the public highway C1346 at OS Grid Reference SO 2397, 5485 (point B). It continues by ascending the grassed bank in a generally easterly direction for approximately 80 metres, then turns to an east-north-easterly direction for approximately 80 metres to the outer yard at Llan-y-felin OS Grid Reference SO 2412, 5486 (point C). The total distance is approximately 425 metres.</p>	Undefined in the statement
Bridleway GD1461 Points M-N-O-P-Q	<p>The section of bridleway GD1461 to be diverted commences at the junction with bridleway GD1457 at OS Grid Reference SO 2430, 5497 (point M). It ascends the grassed bank in a generally north-north-westerly direction and follows alongside the field boundary for approximately 200 metres to a bridle gate at OS Grid Reference SO 2465, 5516 (point N). The path turns to a generally easterly direction and follows alongside the field boundary for approximately 50 metres to SO 2431, 5516 (point O) before turning to follow a north-north-easterly direction and then a north-north-westerly direction around the field boundary for approximately 175 metres and through the bridle gate at OS Grid Reference SO 2429, 5533 (point P). It continues to follow along the field boundary in a generally northerly direction for approximately 100 metres through a bridle gate to meet bridleway GD1462 at OS Grid Reference SO 2430, 5543 (point Q). The total distance is approximately 525 metres.</p>	

PART 2
Description of site of new path or way

<u>Section of highway as indicated on plan</u>	<u>Position</u>	<u>Width</u>
Bridleway GD1457 Points A-D-E-F-G-H-I- J-K-L-C	<p>The proposed new route of bridleway GD1457 shown by a bold broken black line on the attached plan commences at OS Grid Reference SO 2394, 5459 (point A). It follows a generally east-north-easterly direction, parallel with the field boundary, for approximately 100 metres to the field gate in the boundary at OS Grid Reference SO 2403, 5463 (point D). The route then turns to follow a more north-north-easterly direction for approximately 18 metres to join the line of existing footpath GD1441 at OS Grid Reference SO 2404, 5464 (point E). The path continues in a generally north-north westerly direction for approximately 53 metres along a path within a wooded area and through a field gate at OS Grid Reference SO 2402, 5469 (point F). It then turns to travel in a north-easterly direction along the property boundary for 50 metres before deviating inwardly for 5 metres to traverse Gladestry Brook via a proposed bridge at OS Grid Reference SO 2406, 5474 (point H). The path then turns to travel in an east-north easterly direction for approximately 10 metres to OS Grid Reference SO 2407, 5474 (point I) to follow alongside the boundary fence for approximately 85 metres and through a bridle gate adjacent to the existing cattle grid at OS Grid Reference SO 2410, 5481 (point J) to meet the public highway C1346. The northern section of the bridleway <i>starts</i> 15 metres to the west at OS Grid Reference SO 2409, 5484 (point K) and travels in a generally north-north-easterly direction for 32 metres through a field gate and then to a further field gate at OS Grid Reference SO 2410, 5485 (point L). It travels for approximately another 15 metres to join the existing bridleway at OS Grid Reference SO 2412, 5486 (point C). The</p>	3 metres

total distance is approximately 383 metres.

Bridleway GD1461 Points R-S-T-U-V	The proposed new route of the bridleway commences at a junction with bridleway GD1457 on an existing stoned track at OS Grid Reference SO 2425, 5493 (point R). It continues to follow along the track in a generally northerly direction for approximately 65 metres to OS Grid Reference SO 2424, 5500 (point S) where it deviates from the stoned track to travel in a north westerly direction for approximately 112 metres along a grassed track to OS Grid Reference SO 2416, 5507 (point T). It then travels in a more northerly direction for approximately 85 metres and through a field gate at OS Grid Reference SO 2414, 5516 (point U). The route continues in a northerly direction along the field boundary for approximately 265 metres and through a field gate in the common land boundary to meet existing bridleway GD1462 at OS Grid Reference SO2414, 5543 (point V). The total distance to be created is approximately 527 metres.	3 metres
--------------------------------------	---	----------

PART 3 **Conditions and Limitations**

<u>Position of path or way to which conditions and limitations apply</u>	<u>Limitations and conditions</u>
OS Grid Reference SO 2403, 5463 (point D)	Field gate, meeting current British Standard (BS5709:2006)
OS Grid Reference SO 2402, 5469 (point F)	Field gate, meeting current British Standard (BS5709:2006)
OS Grid Reference SO 2410, 5481 (point J)	Bridle gate meeting current British Standard (BS5709:2006)
OS Grid Reference SO 2409, 5484 (point K).	Field gate, meeting current British Standard (BS5709:2006)
OS Grid Reference SO 2410, 5485 (point L)	Field gate, meeting current British Standard (BS5709:2006)
OS Grid Reference SO 2414, 5516 (point U)	Field gate, meeting current British Standard (BS5709:2006)

OS Grid Reference SO2414,
5543 (point V)

Field gate, meeting current British Standard
(BS5709:2006)

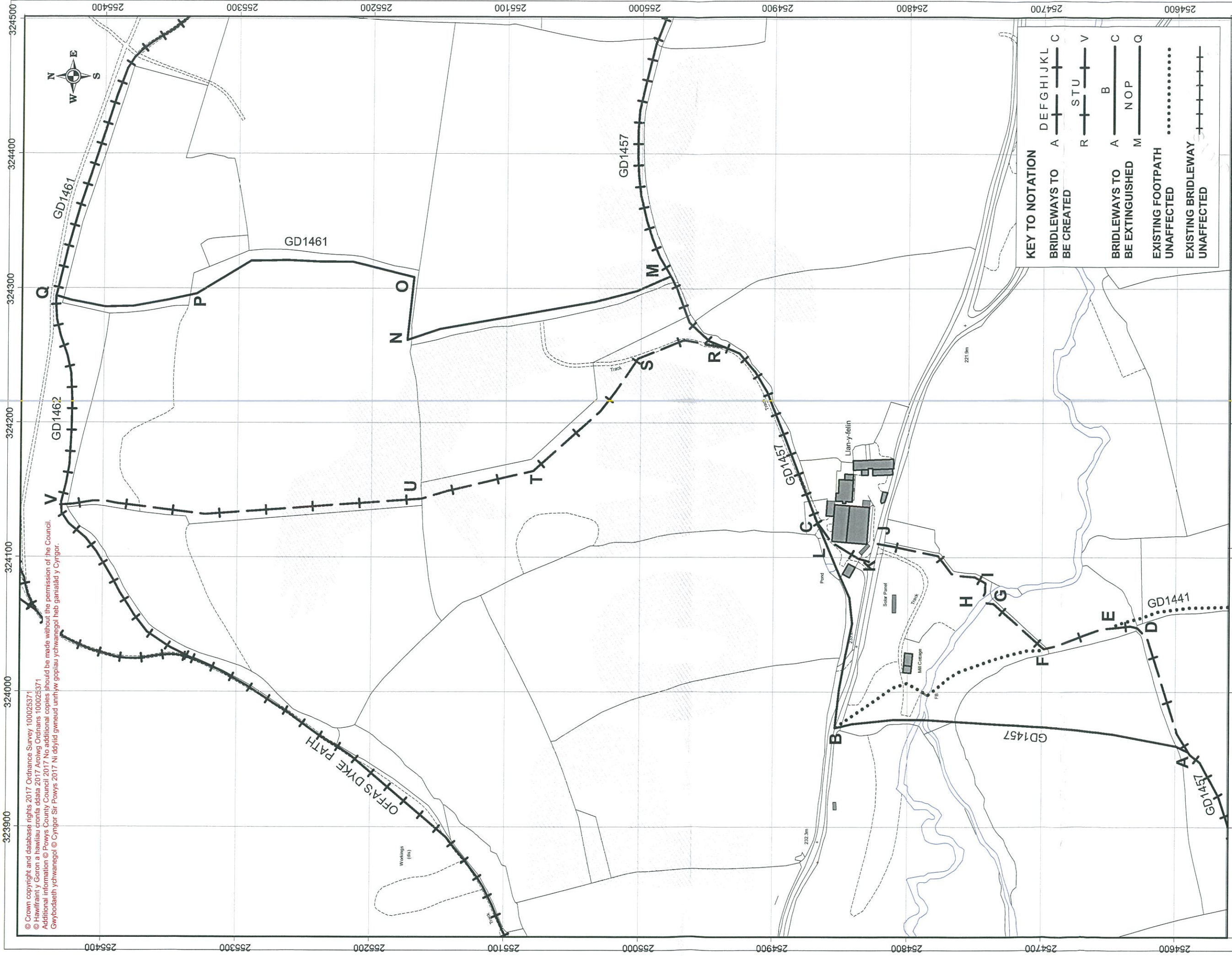

© Crown copyright and database rights, 2017 Ordnance Survey 100025371
 © Hwlfrainnly Goron a hawliau cronfa ddata 2017 Arolwg Ordnans 100025371
 Additional information © Powys County Council 2017 No additional copies should be made without the permission of the Council.
 Gwybodaeth ychwanegol © Cyngor Sir Powys 2017 Ni ddylid gwneud unrhyw gopïau ychwanegol heb ganiatâd y Cyngor.

**Public path diversion Order:
 Public bridleways GD1457 (PT) & GD1461 (PT)
 Mill Cottage and Llan-y-felin, Community of Gladestry
 OSGR SO 240,548**

Cyngor Sir Powys County Council

Printed by: RCS/ROW/CEL Date: 12/04/2017

Scale 1:2500